

Snit. A-B-C.

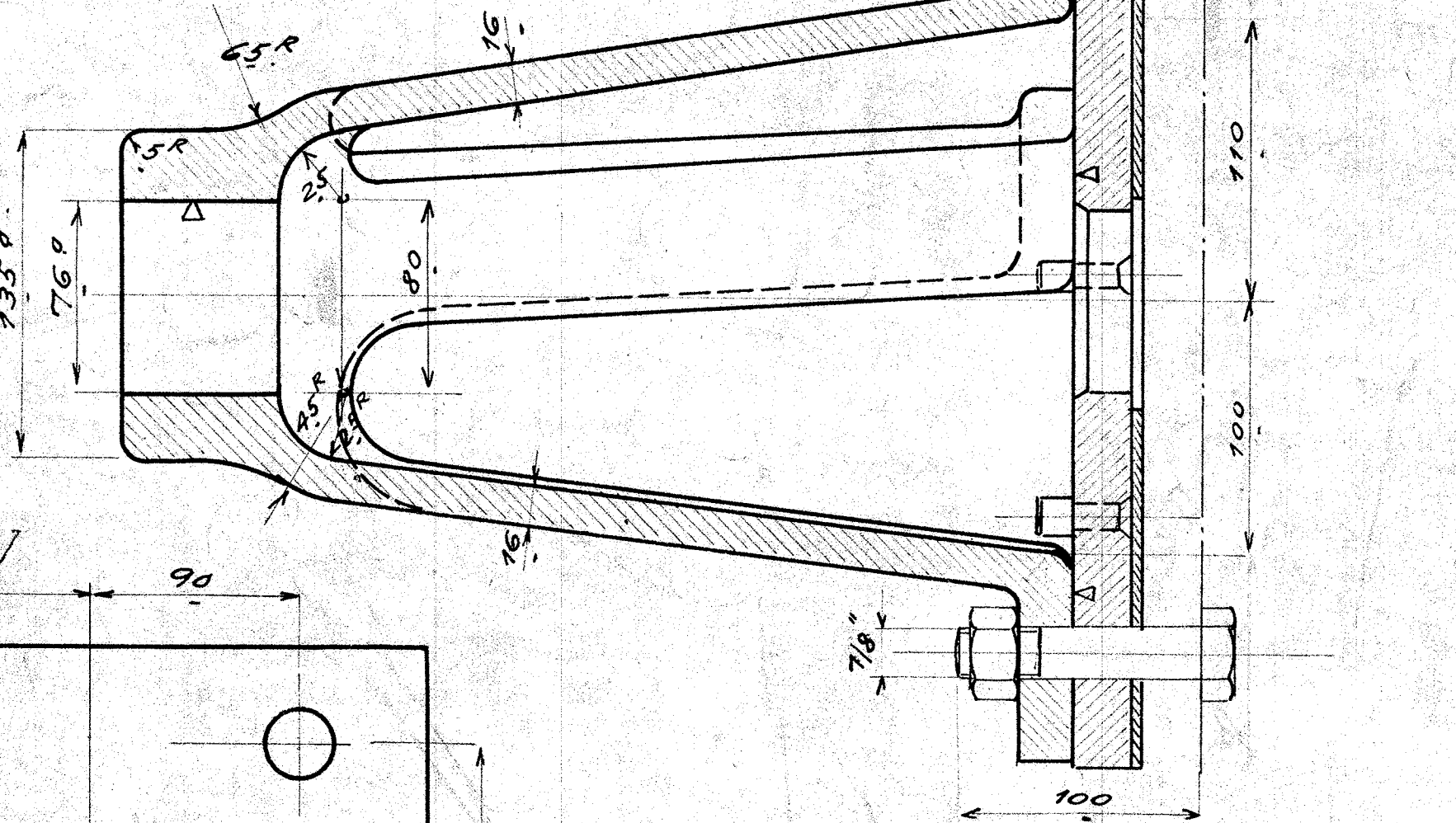

.Ned.

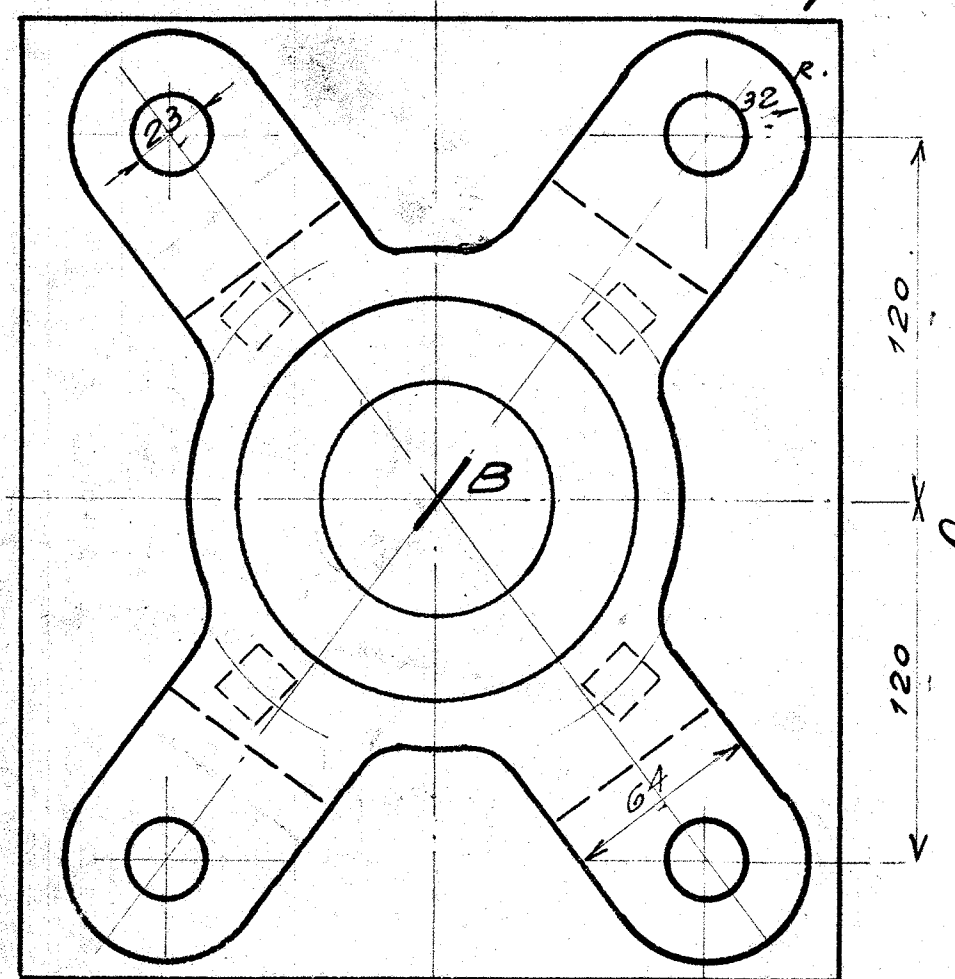

1/c

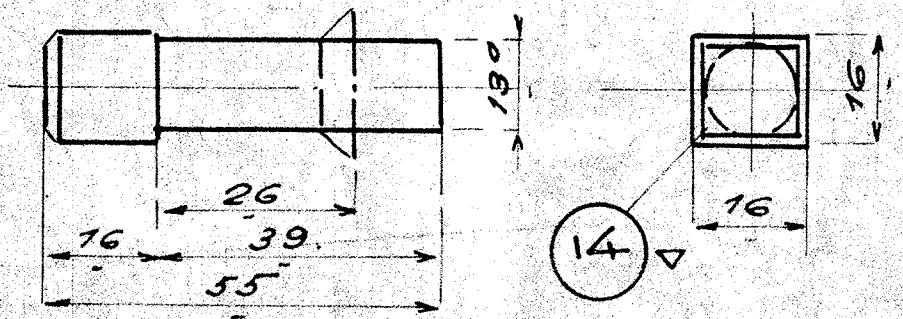
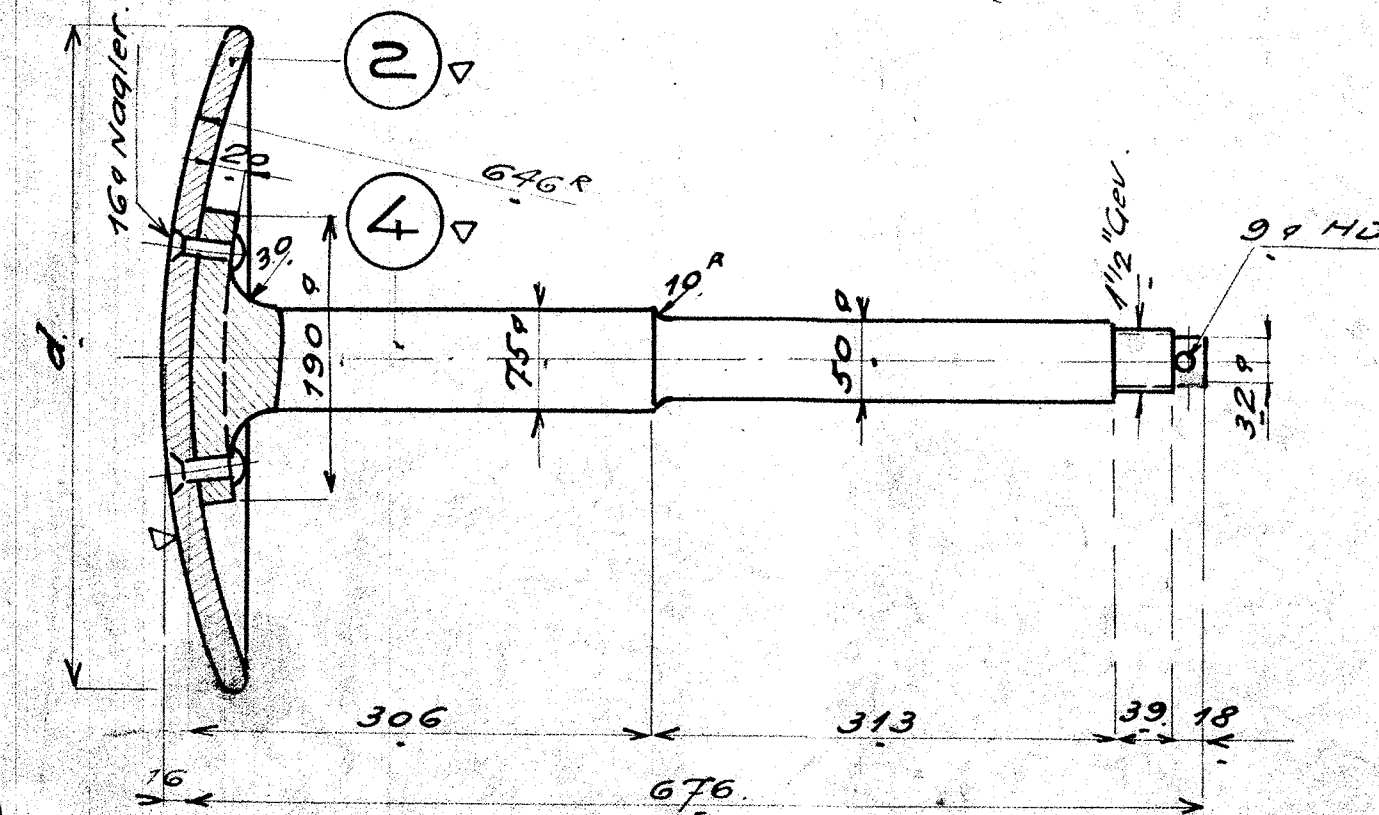
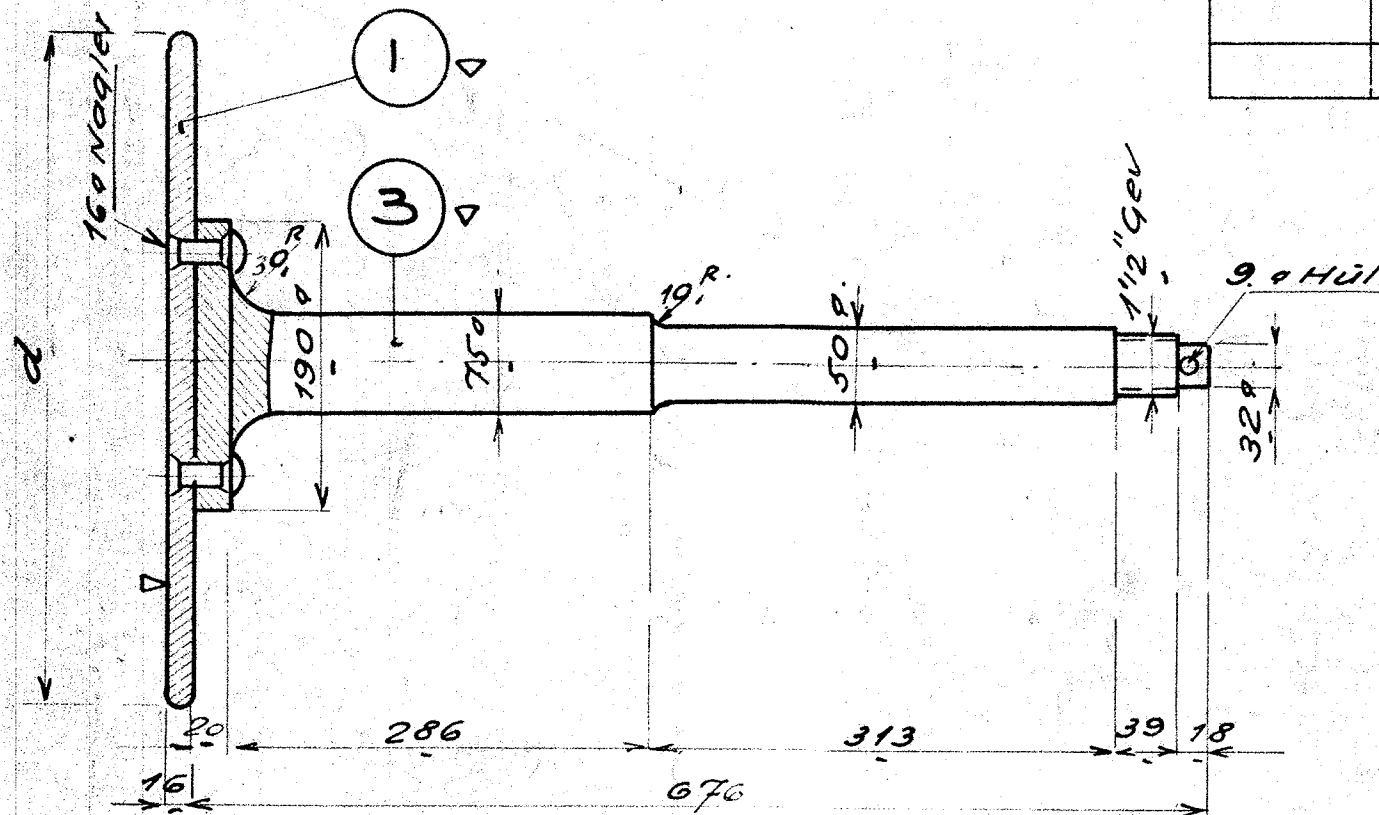

d	Ordre Nr.
450	39700
"	44844
"	46800
400	46846
"	46900
"	47000
"	47010
"	47020
"	47030
"	47147
"	47200
"	47847
450	48300
"	52500
400	56200 og 56210
"	57650

1	2	Büfferstiver-plan	Fluss Jern	930
1	2	Büfferstiver-plan	Fluss Jern	930
2	2	do - bilet	"	460-19
3	2	Büfferstokke.	"	470-19
4	2	do.	"	100-19
5	16	Nagler 16x58	Nitte Jern	920
6	4	Büfferkryds	Fluss Jern	100-19
7	4	Stiver	"	130-19
8	4	Büfferfedre	152x245 Flader	100-19
9	4	Büfferplader	Fluss Jern	1150x
10	4	Bøsninger	"	330x26
11	4	Møttr. 1 1/2" engl.	Nitte Jern	75x180
12	4	Splitter. 9x60	Fluss Jern	75x180
13	4	Pakninger	Pap	1120x
14	16	Styrestifter	Fluss Jern	330x4
15	16	Bolte 7/8" x 100	106L 528 STA7. 40507 Mh.L.2	16-16
16	16	Møttrik 7/8"	Fluss Jern	960

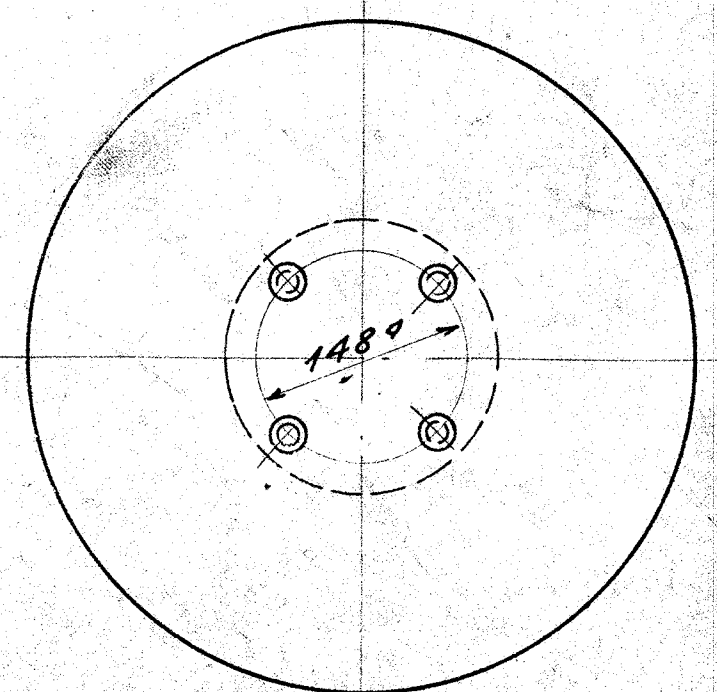
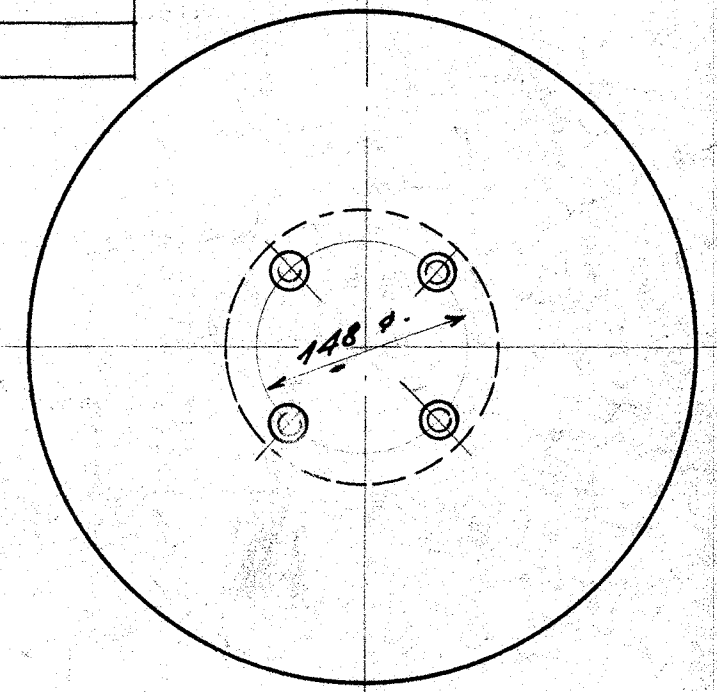

[...] Klammemaal galder for Litra. Mv 106L.

Büffer
Diesel-elekt. 420HK Motorloko. 1. Ba 2
Gr. 10
1:1 1:5
1:2.5 106. L 156
30.8.28
Jhmw